

RECIPIENT \_\_\_\_\_

UNIT(mm)

THE THIRD ANGLE

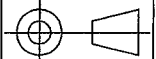

REMARK

# SAMPLE

Products that comply with the RoHS Directive.

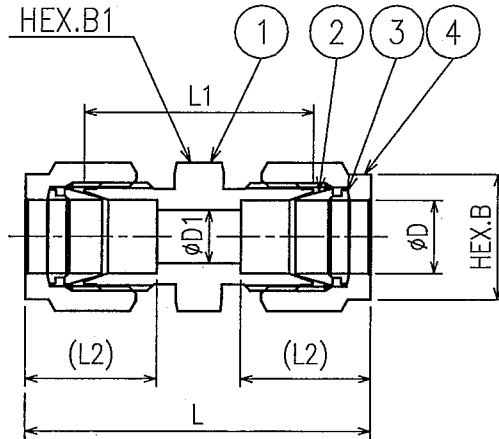

NOMINAL DIA.D	D1	B	B1	L	L1	L2	ITEM No.
3.2	2.3	12	12	35.7	22.4	13	PDWF-3.2-R
6.35	4.8	14	14	40.9	26.2	15.4	PDWF-6.35-R
9.52	7.1	17	17	45.4	30.2	17.2	PDWF-9.52-R
12.7	10.4	22	22	51.5	31	23	PDWF-12.7-R
15.88	12.7	26	24	52	31.8	24.4	PDWF-15.88-R
19.05	15.7	29	27	53.5	33.3	24.4	PDWF-19.05-R

REV. NO.	DATE	REVISED DESCRIPTION	REVISED	APPD.	14				
					13				
					12				
					11				
REVISION					10				
DATE	1.25.'12	TEST PRESS.			9				
SCALE	FREE	ITEM	FLUID		8				
APPD.	<i>J. Adh...</i>	SHELL			7				
CHKD.	<i>J. Adh...</i>	SEAT			6				
DESIGN	<i>K. Shoji</i>	BACKSEAT			5				
		SEAL			4	NUT	C3604B	2	
					3	BACK RING	C3602B	2	
					2	FRONT RING	C3602B	2	
					1	BODY	C3604B	1	
MODEL NO.					PART.NO.	NAME OF PARTS	MATERIAL	Q'TY	REMARK
TRADEMARK OR MODEL NAME					MATERIAL LIST				
NAME	BRASS POWERFULL-LOK STRAIGHT UNION				DRG.NO.	D331600ER		REV.MARK	0
CAREER							CAB. NO.		

RECIPIENT \_\_\_\_\_

UNIT (mm) THE THIRD ANGLE 

REMARK \_\_\_\_\_

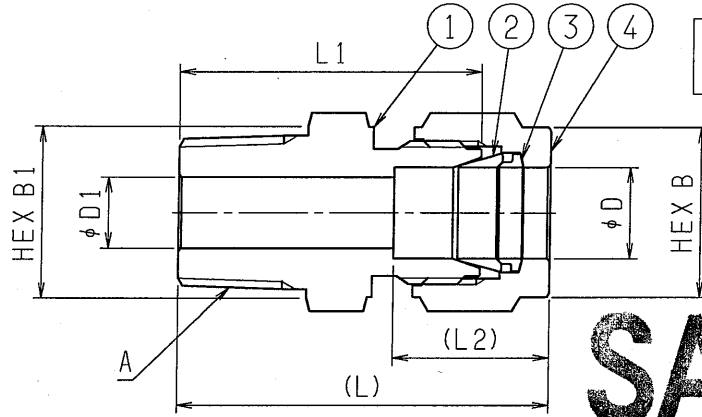

Products that comply with the RoHS Directive.

**SAMPLE**

NOMINAL DIA. D	A	D1	B	B1	L	L1	L2	ITEM No.
3	1/8NPT	2.4	10	12	29.5	23.1	12.7	PDWH-3AN-R
3	1/4NPT	2.4	10	14	35.4	29	12.7	PDWH-3BN-R
4	1/8NPT	2.4	12	12	31.1	24.6	13.6	PDWH-4AN-R
4	1/4NPT	2.4	12	14	36.2	29.7	13.6	PDWH-4BN-R
6	1/8NPT	4.8	14	14	32.6	25.4	15.2	PDWH-6AN-R
6	1/4NPT	4.8	14	14	37.4	30.2	15.2	PDWH-6BN-R
6	3/8NPT	4.8	14	17	38.2	31	15.2	PDWH-6CN-R
6	1/2NPT	4.8	14	22	43.8	36.6	15.2	PDWH-6DN-R
8	1/8NPT	4.8	16	16	34.2	26.7	16.2	PDWH-8AN-R
8	1/4NPT	6.4	16	16	38.7	31.2	16.2	PDWH-8BN-R
8	3/8NPT	6.4	16	17	39.3	31.8	16.2	PDWH-8CN-R
8	1/2NPT	6.4	16	22	44.8	37.3	16.2	PDWH-8DN-R
10	1/8NPT	4.8	19	19	36.1	28.7	17	PDWH-10AN-R
10	1/4NPT	7.9	19	19	40.7	33.3	17	PDWH-10BN-R
10	3/8NPT	7.9	19	19	40.7	33.3	17	PDWH-10CN-R
10	1/2NPT	7.9	19	22	45.5	38.1	17	PDWH-10DN-R
12	1/8NPT	4.8	22	22	38.5	28.7	22.5	PDWH-12AN-R
12	1/4NPT	7.1	22	22	43.1	33.3	22.5	PDWH-12BN-R
12	3/8NPT	9.5	22	22	43.1	33.3	22.5	PDWH-12CN-R
12	1/2NPT	9.5	22	22	47.9	38.1	22.5	PDWH-12DN-R

We use materials with less than 75ppm cadmium.

					14				
					13				
					12				
REV. NO.	DATE	REVISED DESCRIPTION	REVISED	APPD.	11				
REVISION					10				
DATE	5.14. '09	TEST PRESS.			9				
SCALE	FREE	ITEM	FLUID		8				
APPD.	<i>[Signature]</i>	SHELL			7				
CHKD.	<i>[Signature]</i>	SEAT			6				
DESIGN	<i>[Signature]</i>	BACKSEAT			5				
		SEAL			4	NUT	C3604B	1	
					3	BACK RING	C3602B	1	
					2	FRONT RING	C3602B	1	
					1	BODY	C3604B	1	
MODEL NO.									
TRADEMARK OR MODEL NAME									
NAME	BRASS POWERFULL-LOK MALE CONNECTOR				PART. NO.	NAME OF PARTS	MATERIAL	Q' TY	REMARK
	Fujikin Incorporated 株式会社 フジキン				MATERIAL LIST				
CAREER					DRG. NO.	D331617E	REV. MARK	0	
							CAB. NO.		

RECIPIENT \_\_\_\_\_

UNIT(mm)

THE THIRD ANGLE

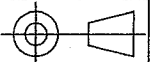

REMARK

# SAMPLE

Products that comply with the RoHS Directive.

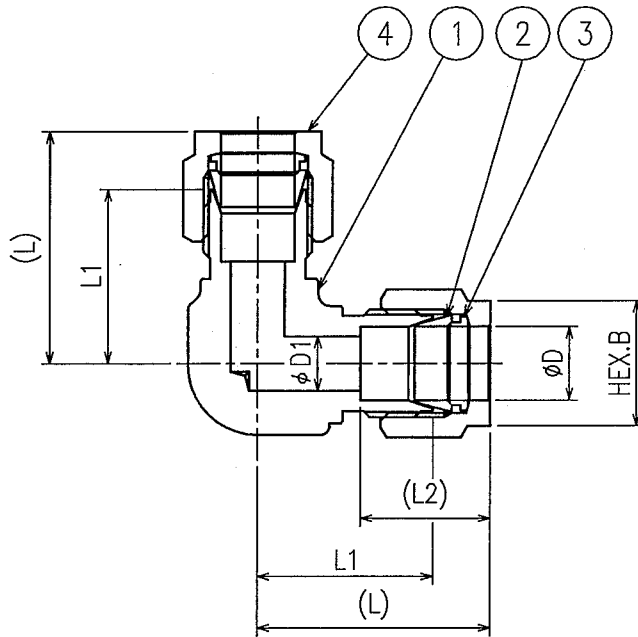

NOMINAL DIA.D	D1	B	L	L1	L2	ITEM No.
3.2	2.3	12	22.4	15.7	13	PDWL-3.2-R
6.35	4.8	14	27	19.6	15.4	PDWL-6.35-R
9.52	7.1	17	30.7	23.1	17.2	PDWL-9.52-R
12.7	10.4	22	36.2	25.9	23	PDWL-12.7-R

REV. NO.	DATE	REVISED DESCRIPTION	REVISED	APPD.	14				
					13				
					12				
					11				
REVISION					10				
DATE	1.25.'12	TEST PRESS.			9				
SCALE	FREE	ITEM	FLUID		8				
APPD.	<i>J. Nakamura</i>	SHELL			7				
CHKD.	<i>J. Nakamura</i>	SEAT			6				
DESIGN	<i>K. Shoji</i>	BACKSEAT			5				
		SEAL			4	NUT	C3604B	2	
					3	BACK RING	C3602B	2	
					2	FRONT RING	C3602B	2	
					1	BODY	C3771B	1	
MODEL NO.					PART.NO.	NAME OF PARTS	MATERIAL	Q'TY	REMARK
TRADEMARK OR MODEL NAME					MATERIAL LIST				
NAME	BRASS POWERFULL-LOK ELBOW UNION				DRG.NO.	TD33016ER	REV.MARK	0	
CAREER							CAB. NO.		